

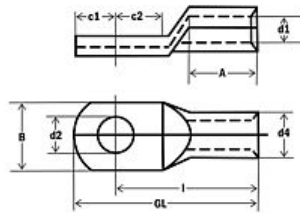

Art.No. 290962

Tubular cable lugs, standard series



Art.No.	290962
EAN	4011923092153
Cross section	25 mm ²
M	10
Material	Copper
Surface protection	Tinned
d1	7 mm
Hole-Ø	10.5 mm
d2	10 mm
c1	12 mm
c2	12 mm
B	18 mm
A	15
v1	2
v2	1
l	34 mm
Connecting angle	Straight
Flange shape	Ring shape
Insulated	No
Dealer Box	300
VPE	50

- For stranded round shaped conductors e.g. VDE 0295 class 2
- For pround sector shaped conuctors
- Annealed material for easier crimping
- Material: 99.9% electrolytic copper E-CU DIN 40500
- Surface: tin-plated
- Vibration and shock proofing DIN EN 61373:1999-11, Cat. 1, Cl. B

available with and without sight hole e.g. 290900/S (add xx xx xx/s when ordering)



Distributed by:

HAUPA GmbH & Co. KG, Lange Straße 40, 42857 Remscheid, Germany, Tel. +49 (0)2191 8418-0
 HAUPA Ibérica S.L.U., C/ Muralla de Sant Llorenç, 37 2ª, 08302 Mataró (Barcelona), Spain, Tel. +34 93-63-82-111
 HAUPA Polska Sp. z o.o., ul. Norwida 11, 55-100 Trzebnica, Poland, Tel. +48 (0)71 387 48 13
 iCON by HAUPA d.o.o., Miše Dimitrijevića 44, 21000 Novi Sad, Serbia, Tel. +381 21 300-2937